

# Kelowna 1 9/16" (149 5/8"X149 5/8")

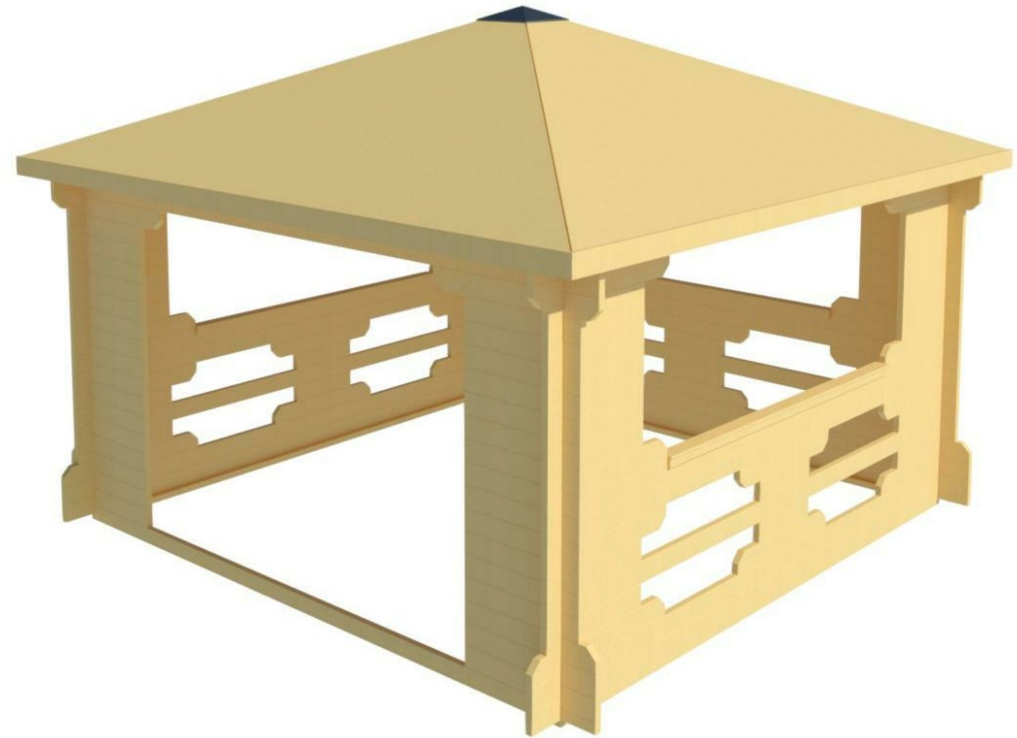

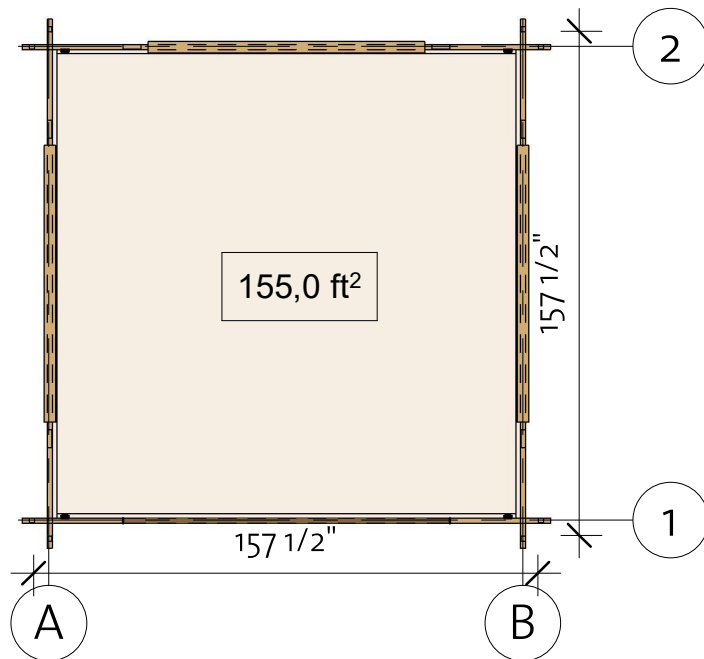
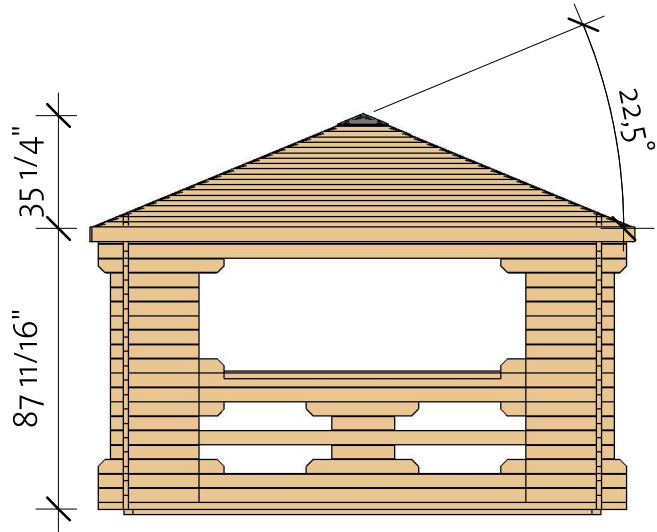
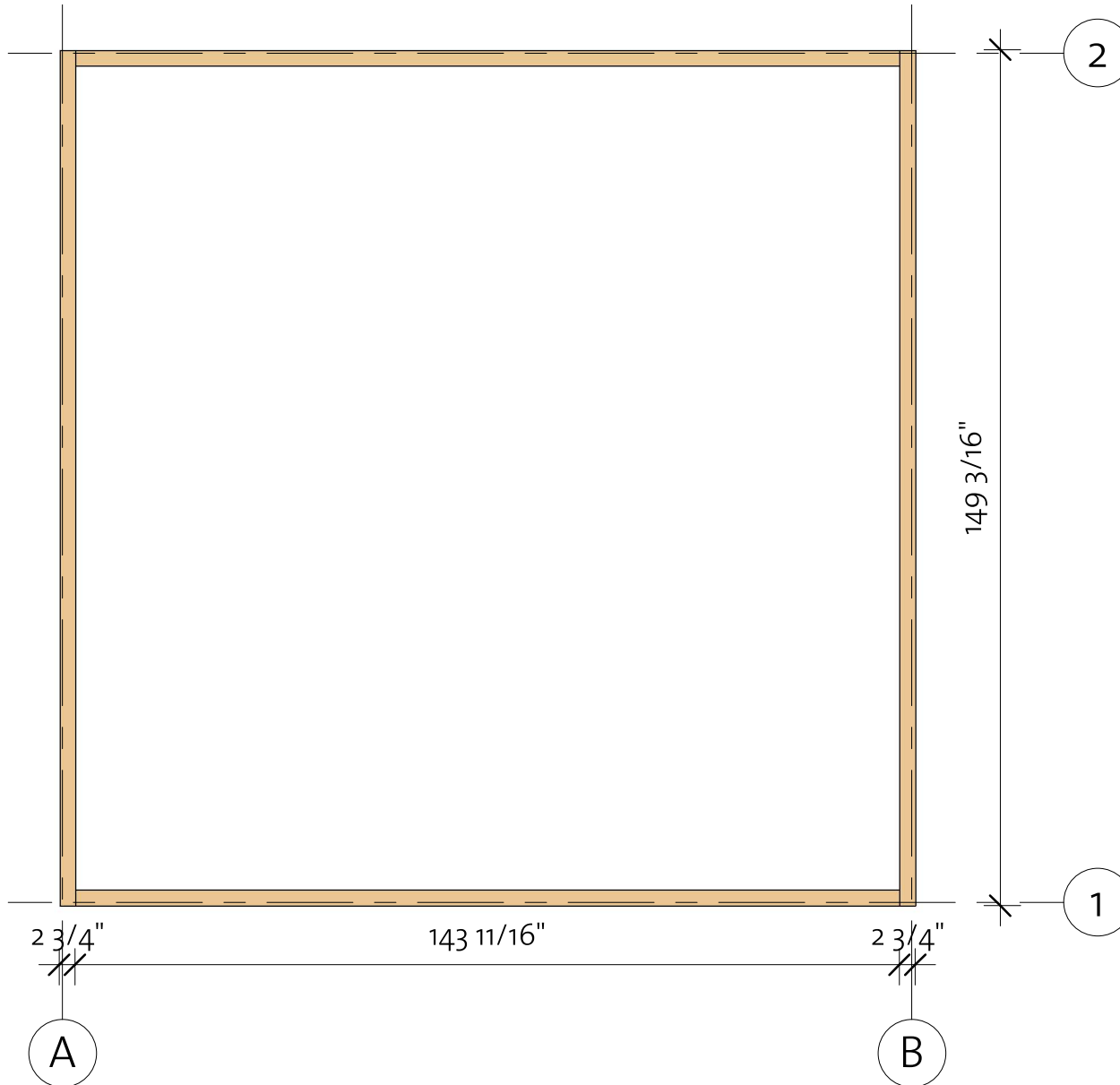

# Kelowna 1 9/16" (149 5/8" X 149 5/8")

Foundation



Impregnated foundation beams				
Mark	Type	Profile	Count	Length

IFB 1	IFB 70x40		2	149 3/16"
IFB 2	IFB 70x40		2	143 11/16"

# Kelowna 1 9/16" (149 5/8" X 149 5/8")

Floor Plan

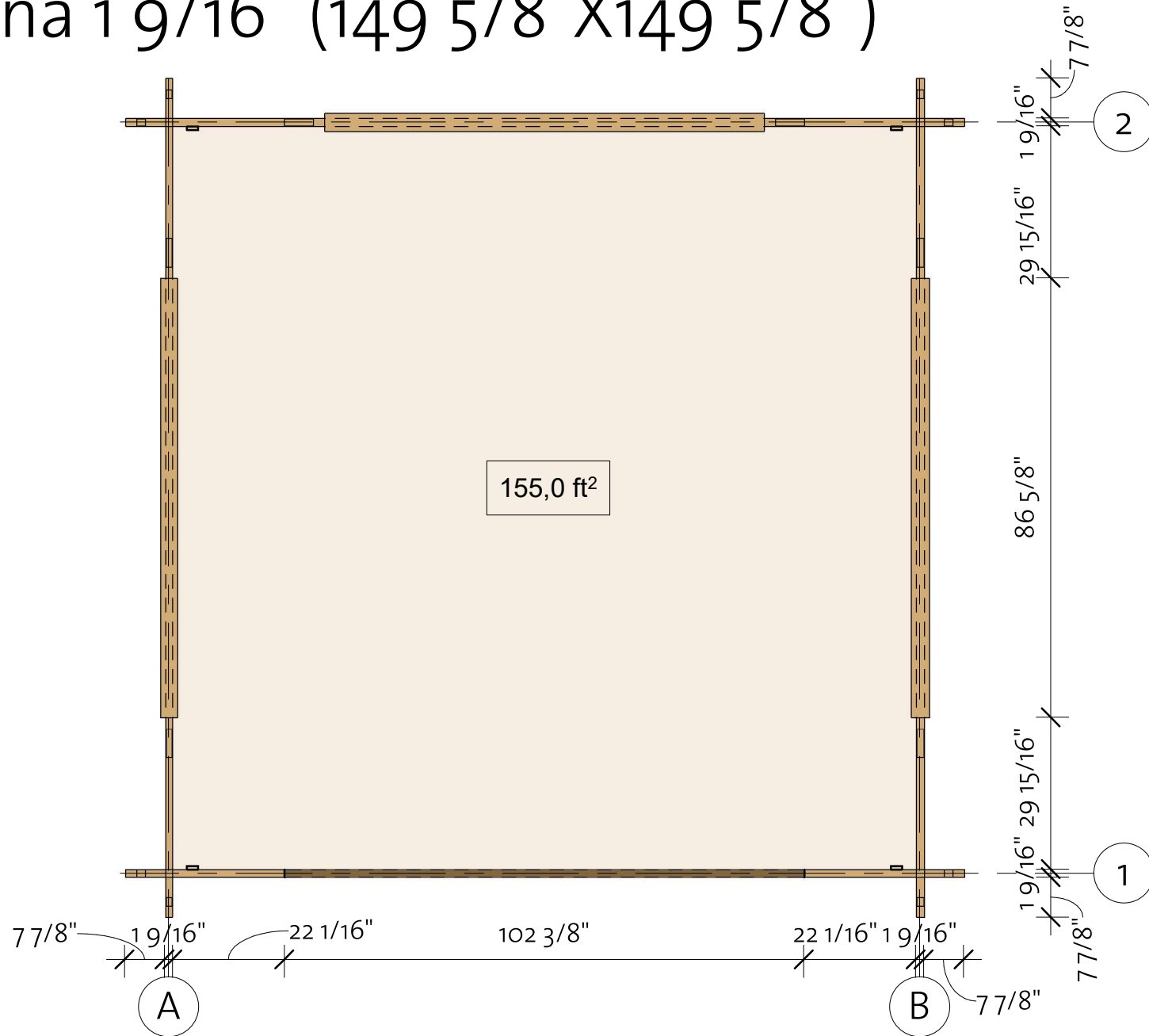

# Kelowna 1 9/16" (149 5/8" X 149 5/8")

Wall 1

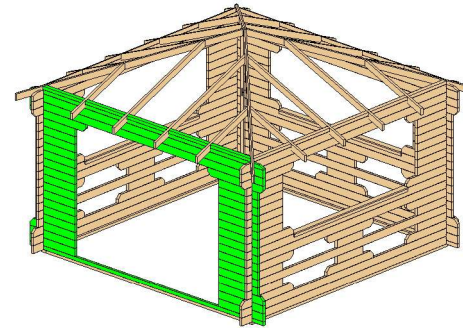

Wall 1			
Mark	Profile	Count	Cut Length

1BL 1	40X57	1	165 3/8"
1LG 1	40X114	26	27 9/16"
1LG 2	40X114	2	31 1/2"
1LG 3	40X114	4	31 1/2"
1LG 4	40X114	2	39 3/8"
1LG 5	40X114	2	165 3/8"
1TL 1	40X63	3	28"
1TL 2	40X63	1	28 9/16"
1TL 3	40X63	1	28 9/16"
1TL 4	40X57 TL	1	165 3/8"

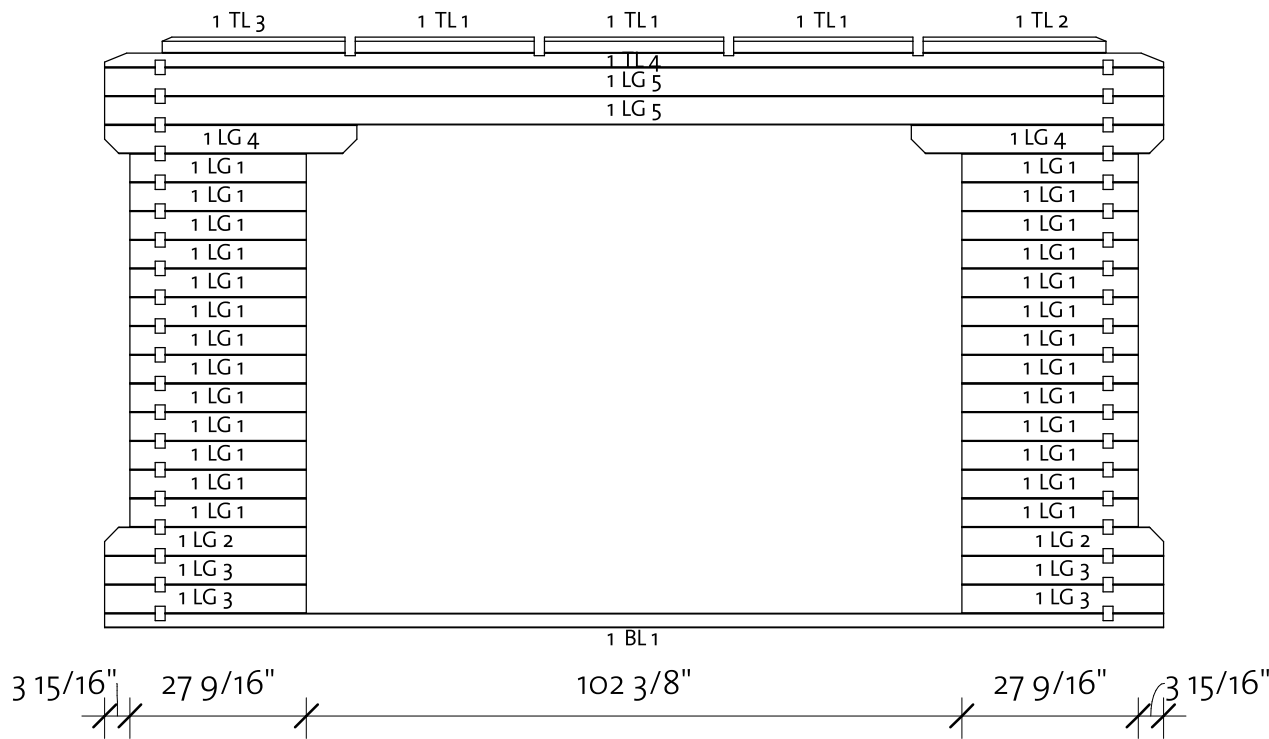

Log Profile Wall 1	
Profile	Profile

40X57	
40X57 TL	

Log Profile Wall 1	
Profile	Profile

40X63	
40X114	

# Kelowna 1 9/16" (149 5/8"X149 5/8")

Wall 2

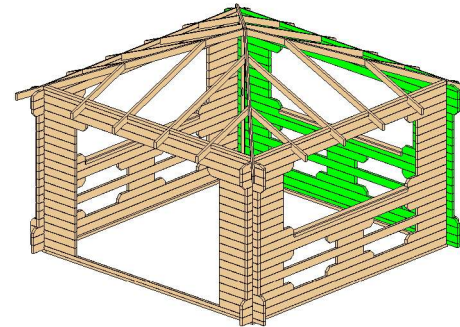

Wall 2			
Mark	Profile	Count	Cut Length

2BL 1	40X57	1	165 3/8"
2LG 1	40X114	2	19 11/16"
2LG 2	40X114	16	27 9/16"
2LG 3	40X114	2	35 7/16"
2LG 4	40X114	1	35 7/16"
2LG 5	40X114	2	39 3/8"
2LG 6	40X114	3	157 1/2"
2LG 7	40X114	1	35 7/16"
2LG 8	40X114	4	165 3/8"
2LG 9	40X114	2	35 7/16"
2LG 10	40X114	2	39 3/8"
2TL 4	40X57 TL	1	165 3/8"
2TL 1	40X63	3	28"
2TL 2	40X63	1	28 9/16"
2TL 3	40X63	1	28 9/16"

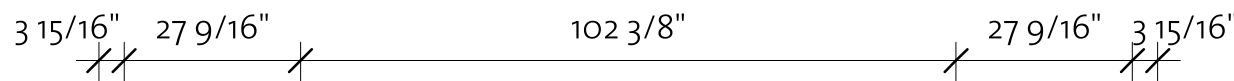
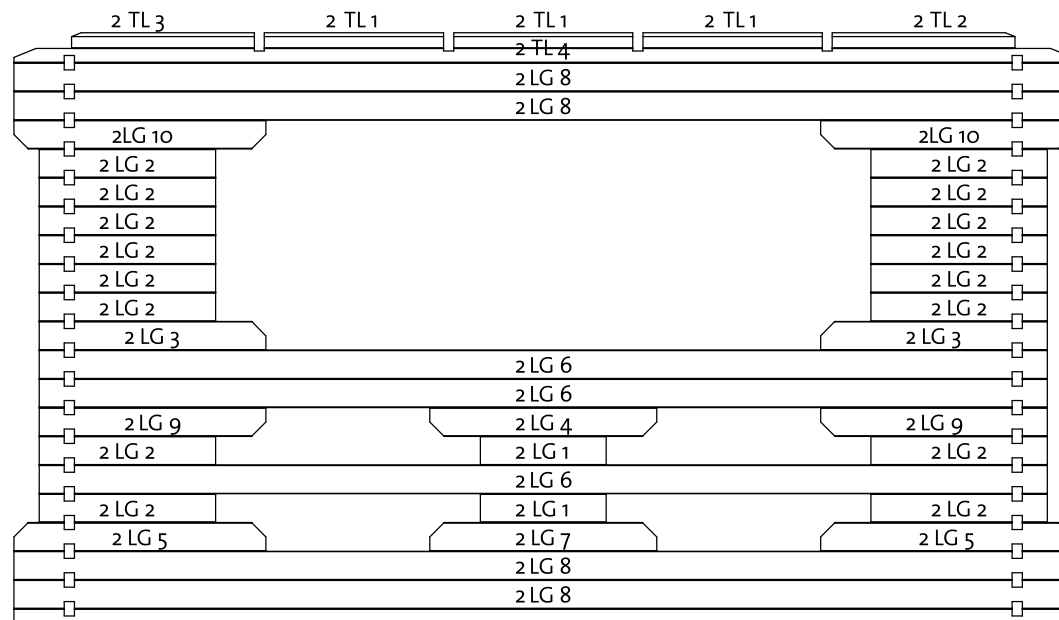

Log Profile Wall 2	
Profile	Profile

40X57	
40X57 TL	

Log Profile Wall 2	
Profile	Profile

40X63	
40X114	

# Kelowna 1 9/16" (149 5/8" X 149 5/8")

Wall A

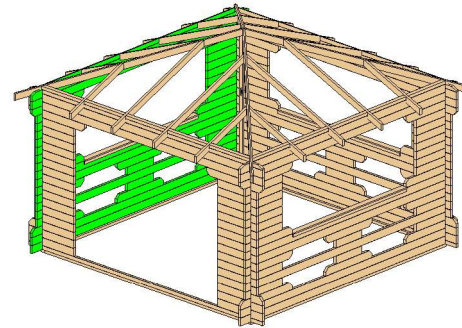

Wall A			
Mark	Profile	Count	Cut Length

ALG 1	40X114	2	19 11/16"
ALG 2	40X114	18	27 9/16"
ALG 3	40X114	1	35 7/16"
ALG 4	40X114	2	35 7/16"
ALG 5	40X114	2	35 7/16"
ALG 6	40X114	1	35 7/16"
ALG 7	40X114	2	39 3/8"
ALG 8	40X114	3	157 1/2"
ALG 9	40X114	1	165 3/8"
ALG 10	40X114	3	165 3/8"
ALG 11	40X114	2	39 3/8"
ATL 1	40X63	3	28"
ATL 2	40X63	1	28 9/16"
ATL 3	40X63	1	28 9/16"

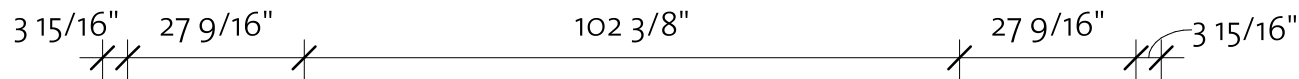
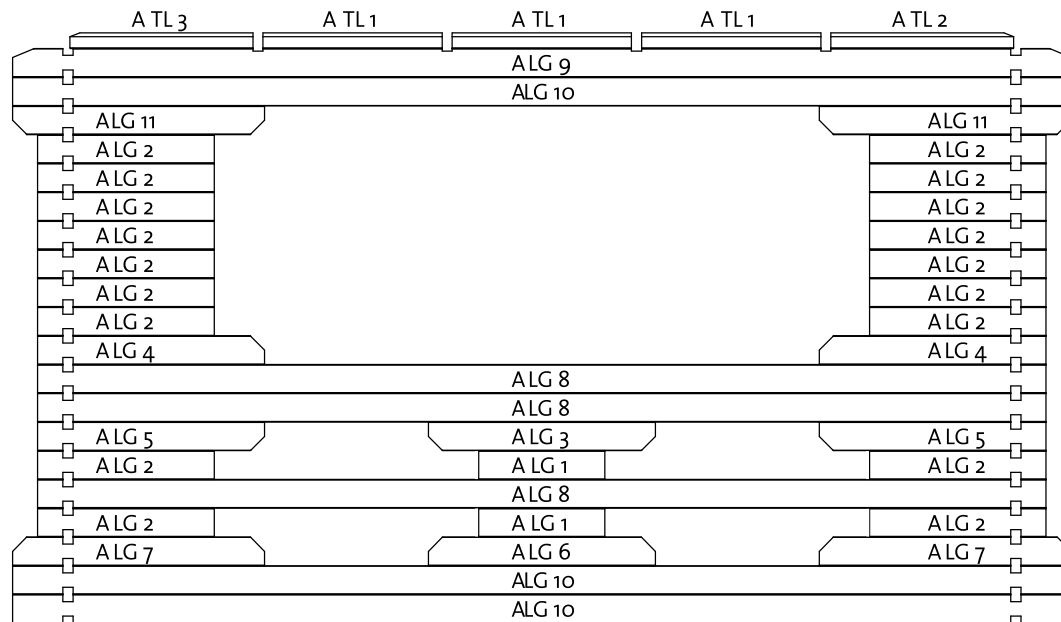

Log Profile Wall A	
Profile	Profile

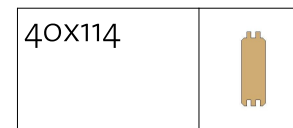

Log Profile Wall A	
Profile	Profile

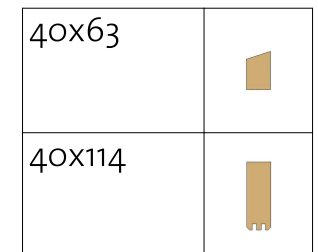

# Kelowna 1 9/16" (149 5/8"X149 5/8")

Wall B

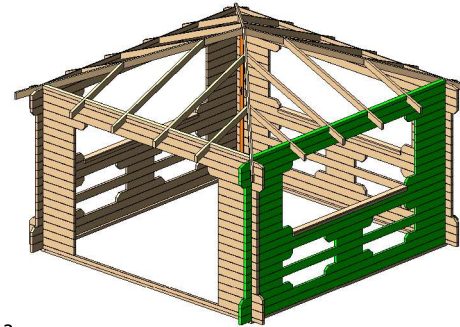

Wall B			
Mark	Profile	Count	Cut Length

BLG 1	40x114	2	19 11/16"
BLG 2	40x114	18	27 9/16"
BLG 5	40x114	4	35 7/16"
BLG 6	40x114	2	35 7/16"
BLG 7	40x114	4	39 3/8"
BLG 8	40x114	3	157 1/2"
BLG 9	40x114	1	165 3/8"
BLG 10	40x114	3	165 3/8"
BTL 1	40x63	3	28"
BTL 2	40x63	1	28 7/16"
BTL 3	40x63	1	28 9/16"

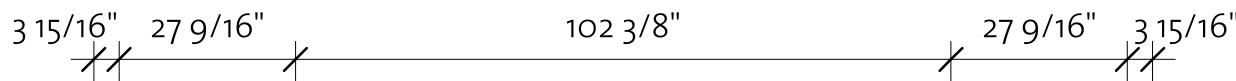
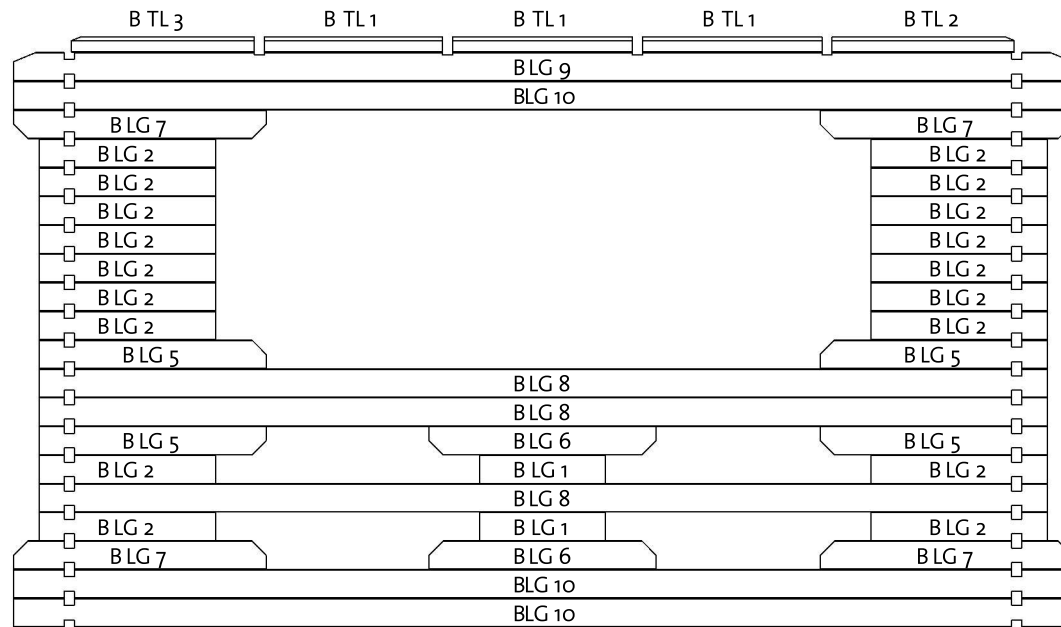

Log Profile Wall B	
Profile	Profile

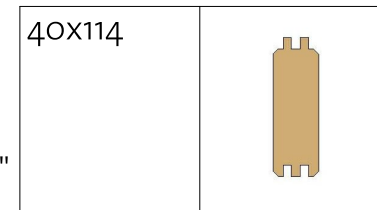

Log Profile Wall B	
Profile	Profile

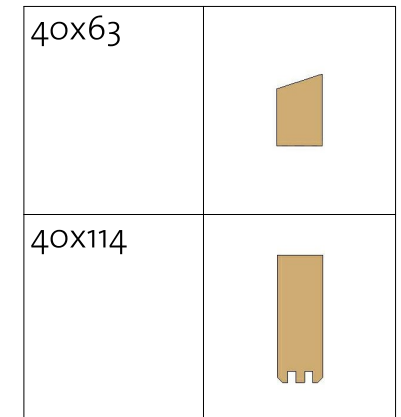

# Kelowna 1 9/16" (149 5/8"X149 5/8")

Roof 1

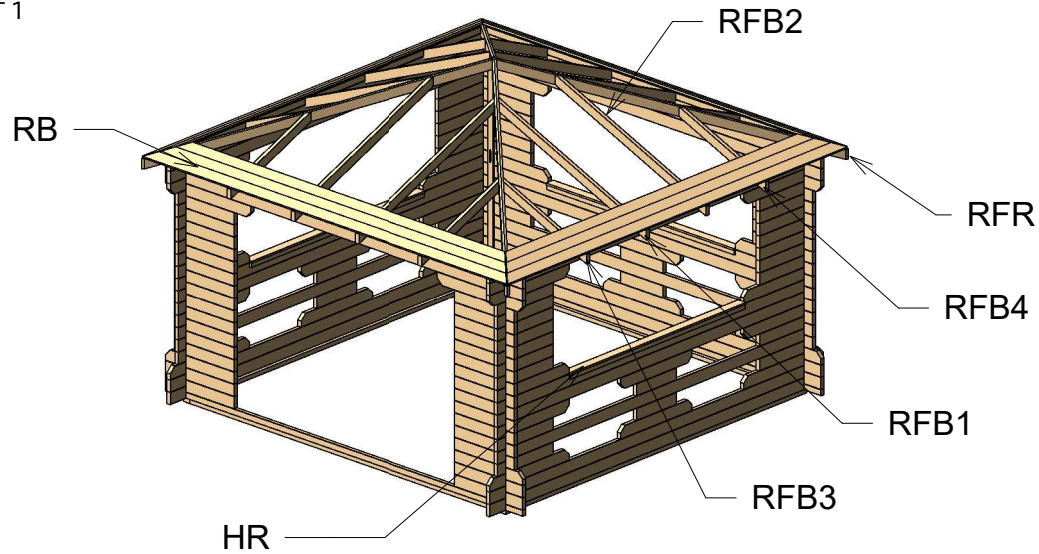

Roof				
Mark	Type	Profile	Count	Length

RFB1	40x85		4	76 9/16"
RFB2	40x85		4	76 9/16"
RFB3	40x85		4	44 9/16"
RFB4	40x85		4	44 9/16"
RFR	40x94		4	124 7/8"

Roofboards				
Mark	Type	Profile	Count	Length

RB 1	Roofboard 18x110		4	8 9/16"
RB 2	Roofboard 18x110		4	16 9/16"
RB 3	Roofboard 18x110		4	24 9/16"
RB 4	Roofboard 18x110		4	32 9/16"
RB 5	Roofboard 18x110		4	40 9/16"
RB 6	Roofboard 18x110		4	48 9/16"
RB 7	Roofboard 18x110		4	56 9/16"
RB 8	Roofboard 18x110		4	64 9/16"
RB 9	Roofboard 18x110		4	72 9/16"

Roofboards				
Mark	Type	Profile	Count	Length

RB 10	Roofboard 18x110		4	80 9/16"
RB 11	Roofboard 18x110		4	88 9/16"
RB 12	Roofboard 18x110		4	96 9/16"
RB 13	Roofboard 18x110		4	104 9/16"
RB 14	Roofboard 18x110		4	112 9/16"
RB 15	Roofboard 18x110		4	120 9/16"
RB 16	Roofboard 18x110		4	128 9/16"
RB 17	Roofboard 18x110		4	136 5/8"
RB 18	Roofboard 18x110		4	144 5/8"
RB 19	Roofboard 18x110		4	152 5/8"
RB 20	Roofboard 18x110		4	160 5/8"
RB 21	Roofboard 18x110		4	168 5/8"



# Kelowna 1 9/16" (149 5/8"X149 5/8")

Roof 2

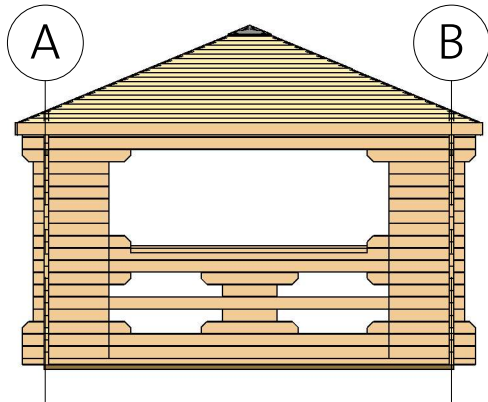

2 Facia

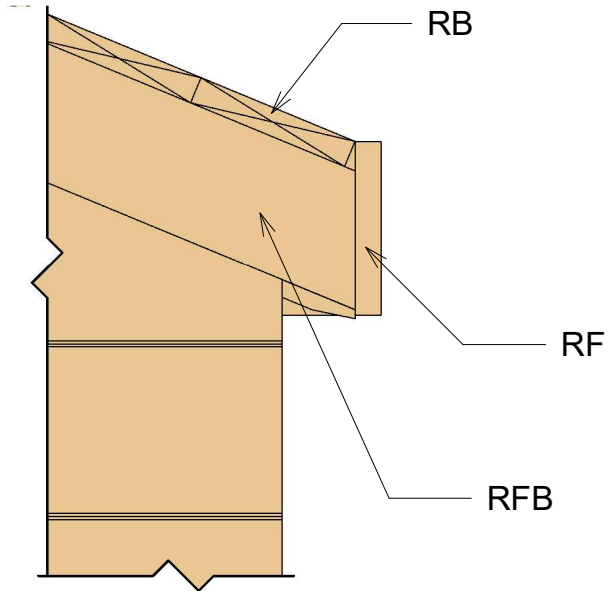

Fascia Schedule				
Mark	Type	Profile	Count	Length

RF	Roof Fascia 18x115		4	169 13/16"
----	-----------------------	--	---	---------------

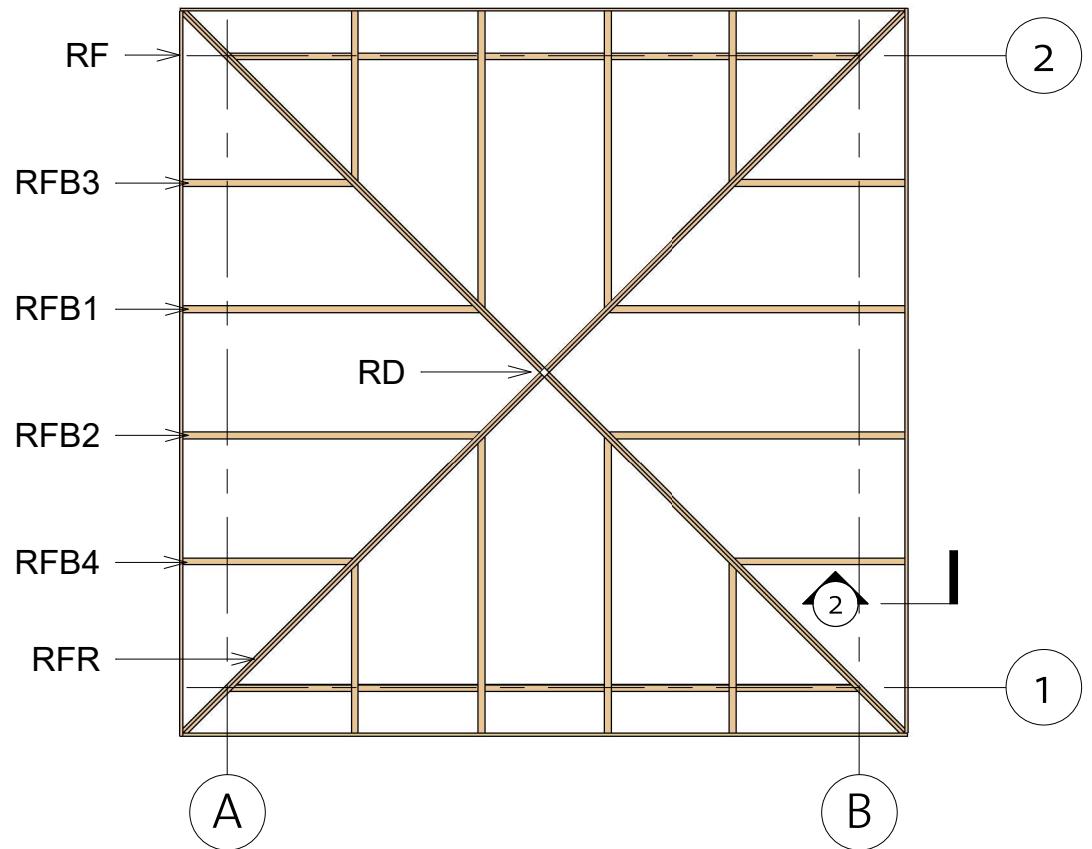

# Kelowna 1 9/16" (149 5/8" X 149 5/8")

Extras



Type	Count	Length
------	-------	--------

Windboard 18x40	4	86 5/8"
--------------------	---	---------

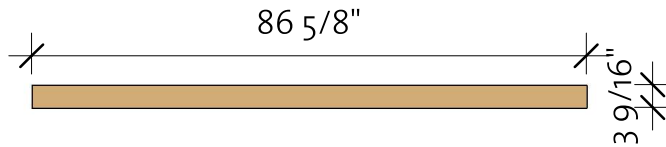

Handrails				
Mark	Type	Profile	Count	Length

HR1	18x90		3	86 5/8"
HR2	18x40		6	86 5/8"

Roof Detail		
Mark	Type	Count

RD	Roof detail	1
----	-------------	---



Fasteners/Extras		
Name	Type	Count

Hitblock	11 13/16"-15 3/4"	
Bolts	M5/16" x 2 3/4"	12
Screws	3/16" x 1 9/16"	30
Screws	1/4" x 5 1/2"	50
Screws	3/16" x 2 3/4"	90
Screws	3/16" x 2"	500

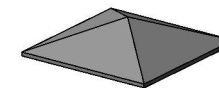

① Roof top



# Kelowna 1 9/16" (149 5/8"X149 5/8")

## List of all items 1

Impregnated foundation beams				
Mark	Type	Profile	Count	Length

IFB 1	IFB 70x40		2	149 3/16"
IFB 2	IFB 70x40		2	143 11/16"

Fascia Schedule				
Mark	Type	Profile	Count	Length

RF	Roof Fascia 18x115		4	169 13/16"
----	-----------------------	---	---	---------------

Roofboards				
Mark	Type	Profile	Count	Length

RB 1	Roofboard 18x110		4	8 9/16"
RB 2	Roofboard 18x110		4	16 9/16"
RB 3	Roofboard 18x110		4	24 9/16"
RB 4	Roofboard 18x110		4	32 9/16"
RB 5	Roofboard 18x110		4	40 9/16"
RB 6	Roofboard 18x110		4	48 9/16"
RB 7	Roofboard 18x110		4	56 9/16"
RB 8	Roofboard 18x110		4	64 9/16"
RB 9	Roofboard 18x110		4	72 9/16"
RB 10	Roofboard 18x110		4	80 9/16"
RB 11	Roofboard 18x110		4	88 9/16"
RB 12	Roofboard 18x110		4	96 9/16"
RB 13	Roofboard 18x110		4	104 9/16"
RB 14	Roofboard 18x110		4	112 9/16"
RB 15	Roofboard 18x110		4	120 9/16"
RB 16	Roofboard 18x110		4	128 9/16"
RB 17	Roofboard 18x110		4	136 5/8"
RB 18	Roofboard 18x110		4	144 5/8"
RB 19	Roofboard 18x110		4	152 5/8"
RB 20	Roofboard 18x110		4	160 5/8"
RB 21	Roofboard 18x110		4	168 5/8"

# Kelowna 1 9/16" (149 5/8"X149 5/8")

## List of all items 2

Wall 1			
Mark	Profile	Count	Cut Length

1BL 1	40X57	1	165 3/8"
1LG 1	40X114	26	27 9/16"
1LG 2	40X114	2	31 1/2"
1LG 3	40X114	4	31 1/2"
1LG 4	40X114	2	39 3/8"
1LG 5	40X114	2	165 3/8"
1TL 1	40X63	3	28"
1TL 2	40X63	1	28 9/16"
1TL 3	40X63	1	28 9/16"
1TL 4	40X57 TL	1	165 3/8"

Wall 2			
Mark	Profile	Count	Cut Length

2BL 1	40X57	1	165 3/8"
2LG 1	40X114	2	19 11/16"
2LG 2	40X114	16	27 9/16"
2LG 3	40X114	2	35 7/16"
2LG 4	40X114	1	35 7/16"
2LG 5	40X114	2	39 3/8"
2LG 6	40X114	3	157 1/2"
2LG 7	40X114	1	35 7/16"
2LG 8	40X114	4	165 3/8"
2LG 9	40X114	2	35 7/16"
2LG 10	40X114	2	39 3/8"
2TL 4	40X57 TL	1	165 3/8"
2TL 1	40X63	3	28"
2TL 2	40X63	1	28 9/16"
2TL 3	40X63	1	28 9/16"

Wall B			
Mark	Profile	Count	Cut Length





BLG 1	40X114	2	19 11/16"
BLG 2	40X114	18	27 9/16"
BLG 5	40X114	4	35 7/16"
BLG 6	40X114	2	35 7/16"
BLG 7	40X114	4	39 3/8"
BLG 8	40X114	3	157 1/2"
BLG 9	40X114	1	165 3/8"
BLG 10	40X114	3	165 3/8"
BTL 1	40X63	3	28"
BTL 2	40X63	1	28 7/16"
BTL 3	40X63	1	28 9/16"

Wall A			
Mark	Profile	Count	Cut Length

ALG 1	40X114	2	19 11/16"
ALG 2	40X114	18	27 9/16"
ALG 3	40X114	1	35 7/16"
ALG 4	40X114	2	35 7/16"
ALG 5	40X114	2	35 7/16"
ALG 6	40X114	1	35 7/16"
ALG 7	40X114	2	39 3/8"
ALG 8	40X114	3	157 1/2"
ALG 9	40X114	1	165 3/8"
ALG 10	40X114	3	165 3/8"
ALG 11	40X114	2	39 3/8"
ATL 1	40X63	3	28"
ATL 2	40X63	1	28 9/16"
ATL 3	40X63	1	28 9/16"

# Kelowna 1 9/16" (149 5/8"X149 5/8")

List of all items 3

Log Profiles	
Profile	Profile
40x57	
40x114	
40x63	
40x114	
40x57 TL	